

MODEL 1402-6358

Maersk style, bolt-on,
works w/ 1/2" pin,
includes brass bushing

SUB FOR: MAERSK 7810885
FITS: MAERSK (Type C) MCIQ 40' REEFER
MATERIAL: STEEL **FINISH:** HOT-DIP GALVANIZED
WEIGHT: 3.91 LBS / 1.77 Kg

MODEL 1402-6359

Maersk style, bolt-on,
works w/ 1/2" pin,
includes brass bushing

SUB FOR: MAERSK 7811045
FITS: MAERSK (Type A) MCIQ 40' REEFER
MATERIAL: ALUMINUM **FINISH:** SELF-COLOR
WEIGHT: 2.17 LBS / 0.98 Kg

MODEL 1402-6360

Maersk style, bolt-on,
works w/ 1/2" pin,
includes brass bushing

SUB FOR: MAERSK 7811406
FITS: MAERSK (Type B) MCIQ 40' REEFER
MATERIAL: ALUMINUM **FINISH:** SELF-COLOR
WEIGHT: 1.91 LBS / 0.87 Kg

MODEL 1402-6361

Maersk style, bolt-on,
works w/ 1/2" pin,
includes brass bushing

SUB FOR: MAERSK 7811407
FITS: MAERSK (Type C) MCIQ 40' REEFER
MATERIAL: ALUMINUM **FINISH:** SELF-COLOR
WEIGHT: 1.88 LBS / 0.85 Kg

MODEL 1402-7372

CIMC style, bolt-on,
works w/ 1/2" pin,
includes brass bushing

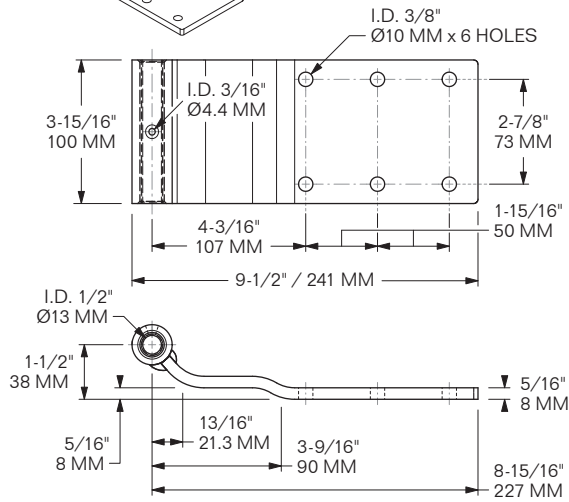

SUB FOR: CIMC 06-025 **FITS:** CIMC REEFER
MATERIAL: STEEL **FINISH:** HOT-DIP GALVANIZED
WEIGHT: 3.78 LBS / 1.71 Kg

MODEL 1402-7412

CIMC style, bolt-on,
works w/ 1/2" pin,
includes brass bushing

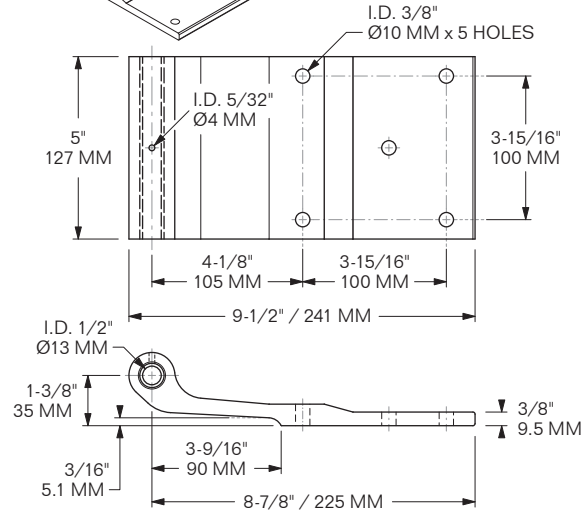

FITS: CIMC 40' REEFER
MATERIAL: ALUMINUM **FINISH:** SELF-COLOR
WEIGHT: 2.46 LBS / 1.12 Kg

MODEL 1402-7413

CIMC style, bolt-on,
works w/ 1/2" pin,
includes brass bushing

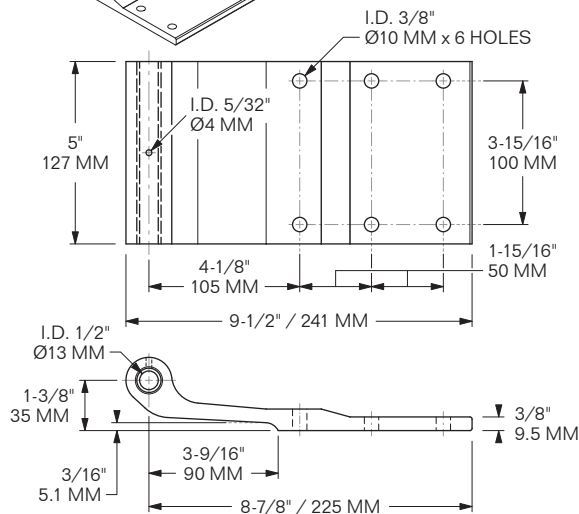

SUB FOR: CIMC 06-022 **FITS:** CIMC 40' REEFER
MATERIAL: ALUMINUM **FINISH:** SELF-COLOR
WEIGHT: 2.47 LBS / 1.12 Kg

MODEL 1402-7475

CIMC/Singamas style, bolt-on,
works w/ 1/2" pin,
includes brass bushings

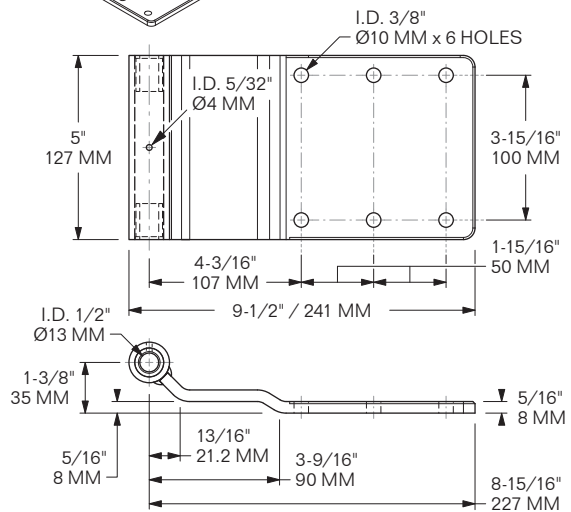

SUB FOR: CIMC 06-018, DA18-A04-S0 & SAEJIN PH12006
FITS: CIMC & SINGAMAS 40' REEFER
MATERIAL: STEEL **FINISH:** HOT-DIP GALVANIZED
WEIGHT: 5.45 LBS / 2.47 Kg

MODEL 1402-7476

CIMC style, bolt-on,
works w/ 1/2" pin,
includes brass bushings

5" 127 MM
I.D. 1-9/16" Ø40 MM
3-9/16" 90 MM
I.D. 3/8" Ø10 MM x 6 HOLES
3-15/16" 100 MM
4-3/16" 107 MM
1-15/16" 50 MM
9-1/2" / 241 MM
I.D. 1/2" Ø13 MM
1-3/8" 35 MM
I.D. 2-13/16" Ø72 MM
5/16" 8 MM
13/16" 21.2 MM
3-9/16" 90 MM
1/8" 3 MM
8-15/16" 227 MM

SUB FOR: CIMC 06-019, 59RFCIMC060211, DA18-A05-S0 & SAEJIN PH12006/1 **FITS:** CIMC 40' REEFER
WORKS WITH: RUBBER DOOR BUMPER 1402-7260
MATERIAL: STEEL **FINISH:** HOT-DIP GALVANIZED
WEIGHT: 5.44 LBS / 2.47 Kg

MODEL 1402-7530

CIMC style, bolt-on,
works w/ 1/2" pin,
includes brass bushings

3-15/16" 100 MM
I.D. 1-9/16" Ø40 MM
3-3/4" 95.3 MM
I.D. 3/8" Ø10 MM x 6 HOLES
2-7/8" 73 MM
4-3/16" 107 MM
1-15/16" 50 MM
9-1/2" / 241 MM
I.D. 1/2" Ø13 MM
1-1/2" 38 MM
I.D. 2-13/16" Ø72 MM
5/16" 8 MM
13/16" 21.2 MM
3-9/16" 90 MM
1/8" 3 MM
8-15/16" 227 MM

SUB FOR: CIMC 06-026 **FITS:** CIMC 40' REEFER
WORKS WITH: DOOR BUMPER 1402-7260
MATERIAL: STEEL **FINISH:** HOT-DIP GALVANIZED
WEIGHT: 3.25 LBS / 1.47 Kg

MODEL 1402-7659

CIMC style, bolt-on,
works w/ 1/2" pin,
includes brass bushings

5" 127 MM
I.D. 3/8" Ø10 MM x 6 HOLES
I.D. 5/32" Ø4 MM
3-15/16" 100 MM
4-3/16" 107 MM
1-15/16" 50 MM
9-1/2" / 241 MM
I.D. 1/2" Ø13 MM
1-9/16" 40 MM
I.D. 2-13/16" Ø72 MM
13/32" 10 MM
3/8" 9 MM
1-3/16" 30 MM
3-5/8" 92 MM
8-15/16" / 227 MM

SUB FOR: CIMC 06-020 **FITS:** CIMC 40' REEFER
MATERIAL: STEEL **FINISH:** HOT-DIP GALVANIZED
WEIGHT: 5.81 LBS / 2.64 Kg

MODEL 1402-7804

CIMC style, bolt-on,
works w/ 1/2" pin,
includes brass bushings

3-15/16" 100 MM
I.D. 3/8" Ø10 MM x 6 HOLES
I.D. 5/32" Ø4 MM
2-7/8" 73 MM
4-3/16" 107 MM
1-15/16" 50 MM
9-1/2" / 241 MM
I.D. 1/2" Ø13 MM
1-3/8" 35 MM
I.D. 2-13/16" Ø72 MM
5/16" 8 MM
13/16" 21 MM
3-9/16" 90 MM
8-15/16" 227 MM

SUB FOR: CIMC 06-018-1 & DA18-A08
FITS: CIMC 40' REEFER
MATERIAL: STEEL **FINISH:** HOT-DIP GALVANIZED
WEIGHT: 4.18 LBS / 1.67 Kg

MODEL 1402-6473

Wabash style, works w/ 1/2" pin,
no bushing required

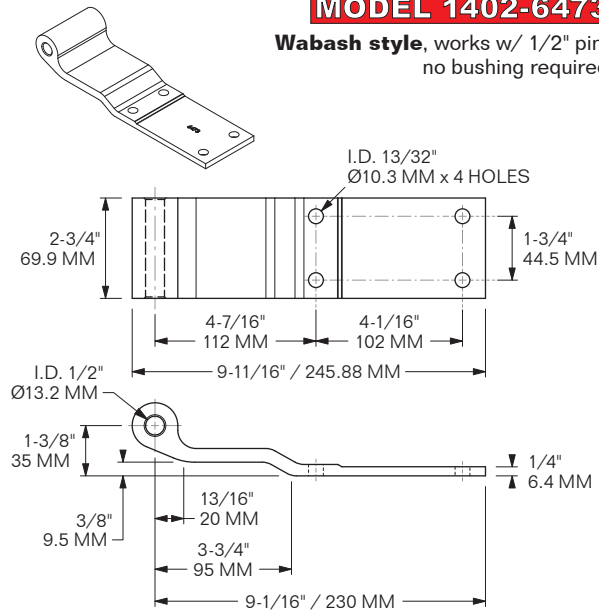

SUB FOR: WABASH 06300291 & 21100291,
FLEET ENG. 022-00975 **WORKS WITH:** 1402-2340 HINGE
BRACKET & 1402-7541 HINGE PIN **MATERIAL:** ALUMINUM
FINISH: SELF-COLOR **WEIGHT:** 1.02 LBS / 0.46 Kg

MODEL 1402-6520

Fruehauf style, works w/ 1/2" pin,
no bushing required

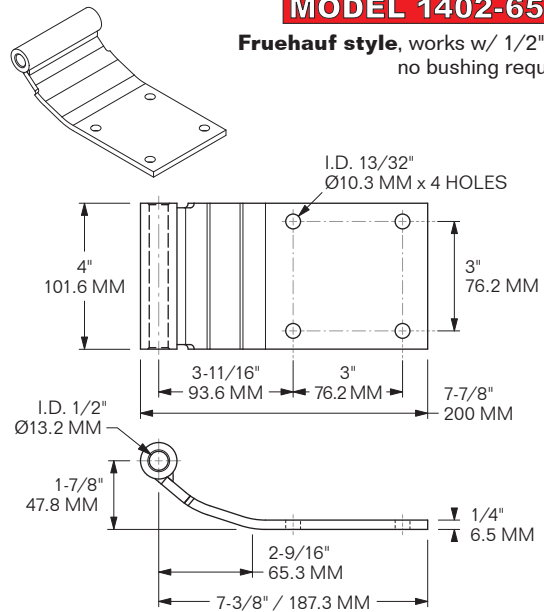

SUB FOR: FRUEHAUF DCE-8681-1, PENZ 60-02,
FLEET ENG. 023-00557 **WORKS WITH:** 1402-7247 HINGE
BRACKET & 1402-6230 HINGE PIN **MATERIAL:** STEEL
FINISH: HOT-DIP GALVANIZED **WEIGHT:** 2.75 LBS / 1.25 Kg

MODEL 1402-6521

Fruehauf style, works w/ 1/2" pin,
no bushing required

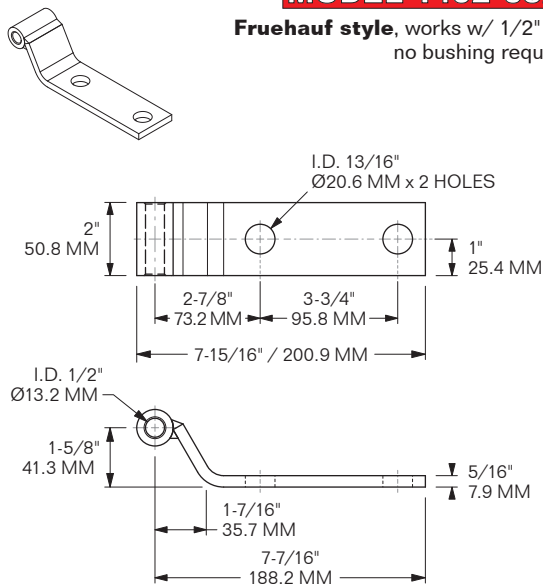

SUB FOR: FRUEHAUF DXA-0687, PENZ 60-01,
FLEET ENG. 022-00013 **WORKS WITH:** 1402-1651
or 1402-2270 HINGE PINS **MATERIAL:** STEEL
FINISH: HOT-DIP GALVANIZED **WEIGHT:** 1.7 LBS / 0.77 Kg

MODEL 1402-7287

Hyundai style, works w/ 1/2" pin,
no bushing included

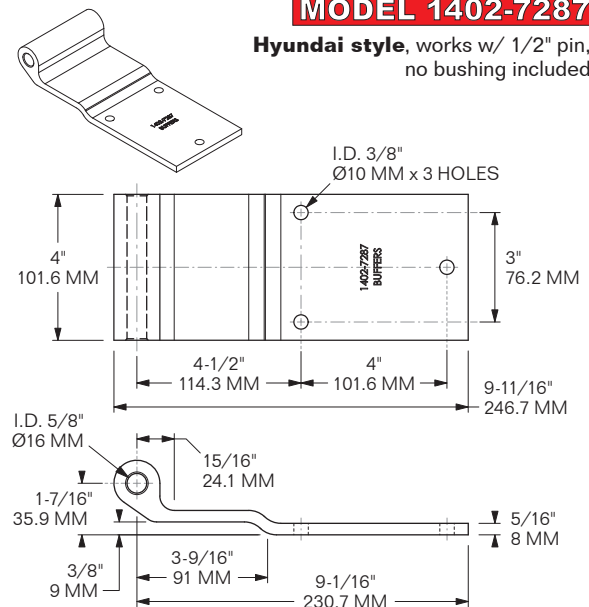

SUB FOR: HYUNDAI 10009668, PENZ 60-17
WORKS WITH: 1402-6230 HINGE PIN
MATERIAL: ALUMINUM **FINISH:** SELF-COLOR
WEIGHT: 1.52 LBS / 0.69 Kg

MODEL 1402-7487

Trailmobile style, works w/ 5/8" pin, no bushing required

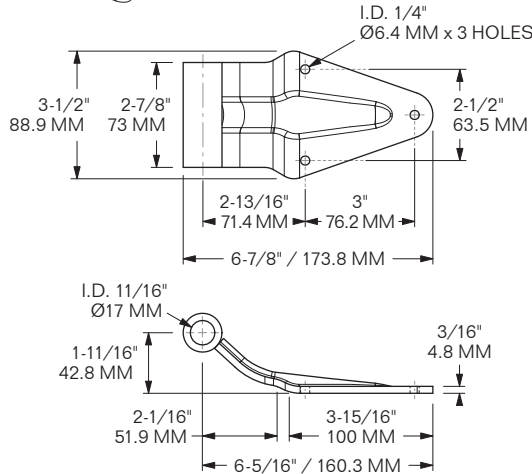

SUB FOR: TRAILMOBILE 515-10-61A, MINER P-6016, FLEET ENG. 023-00008
WORKS WITH: 1402-7532 HINGE BRACKET & 1402-7544 HINGE PIN **MATERIAL:** STEEL
FINISH: ZINC-PLATED **WEIGHT:** 1.33 LBS / 0.6 Kg

MODEL 1402-7489

Utility style, works w/ 5/8" pin, no bushing required

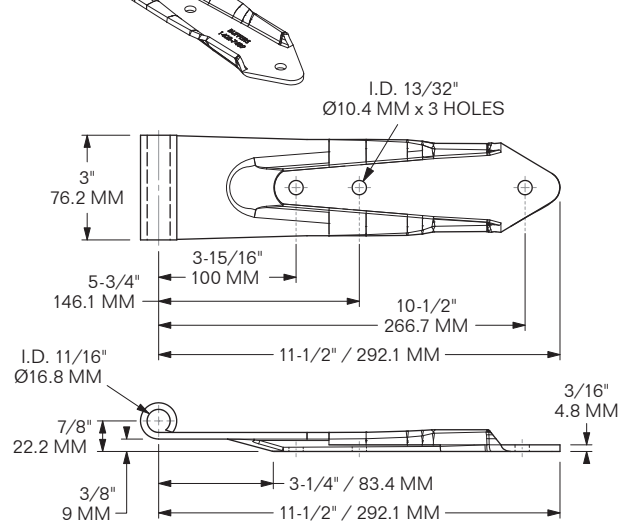

SUB FOR: UTILITY 01-4950-0-004, FLEET ENG. 023-00943
WORKS WITH: 1402-7545 HINGE PIN **MATERIAL:** STEEL
FINISH: ZINC-PLATED **WEIGHT:** 2 LBS / 0.91 Kg

MODEL 1402-7490

Dorsey style, works w/ 1/2" pin, no bushing required

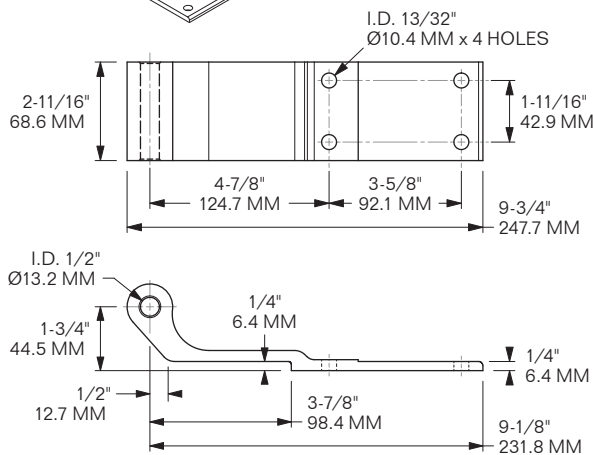

SUB FOR: DORSEY 2810093, FLEET ENG. 022-00888
WORKS WITH: 1402-7538 HINGE BRACKET & 1402-7541 HINGE PIN **MATERIAL:** ALUMINUM
FINISH: SELF-COLOR **WEIGHT:** 1.06 LBS / 0.48 Kg

MODEL 1402-7491

Dorsey style, works w/ 1/2" pin, no bushing required

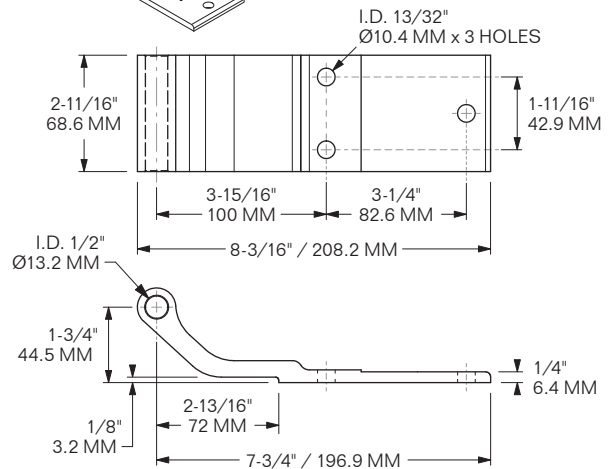

SUB FOR: DORSEY 2810919, FLEET ENG. 022-00889
MATERIAL: ALUMINUM **FINISH:** SELF-COLOR
WEIGHT: 0.81 LBS / 0.37 Kg **WORKS WITH:** 1402-7538 HINGE BRACKET & 1402-7541 HINGE PIN

MODEL 1402-7492

Fruehauf style, works w/ 1/2" pin,
no bushing required

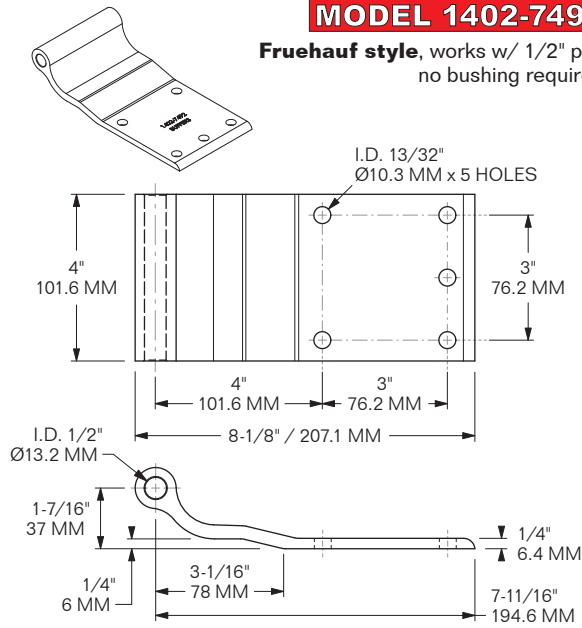

SUB FOR: FRUEHAUF BCF004678001, FLEET ENG. 022-01004
MATERIAL: ALUMINUM **FINISH:** SELF-COLOR
WEIGHT: 1 LB / 0.45 Kg **WORKS WITH:** 1402-2350
 HINGE BRACKET & 1402-6230 HINGE PIN

MODEL 1402-7495

Great Dane style, works w/ 1/2" pin,
includes nylon bushing

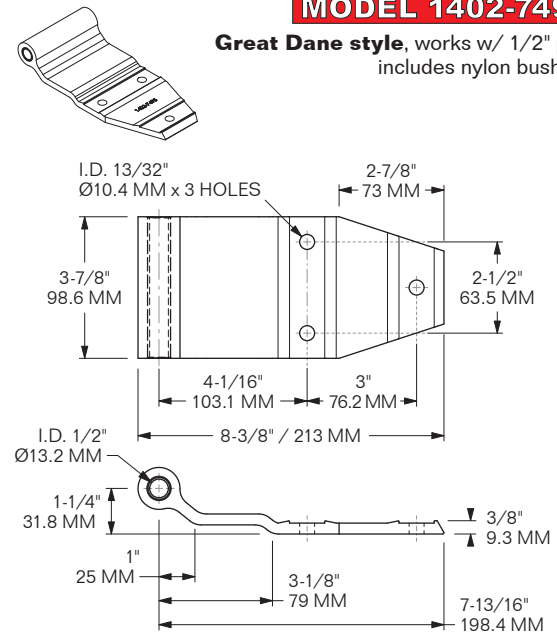

SUB FOR: GREAT DANE 31801018, FLEET ENG. 022-00407
MATERIAL: ALUMINUM **FINISH:** SELF-COLOR
WEIGHT: 1.2 LBS / 0.54 Kg

MODEL 1402-7496

Great Dane style, works w/ 3/8" pin,
no bushing required

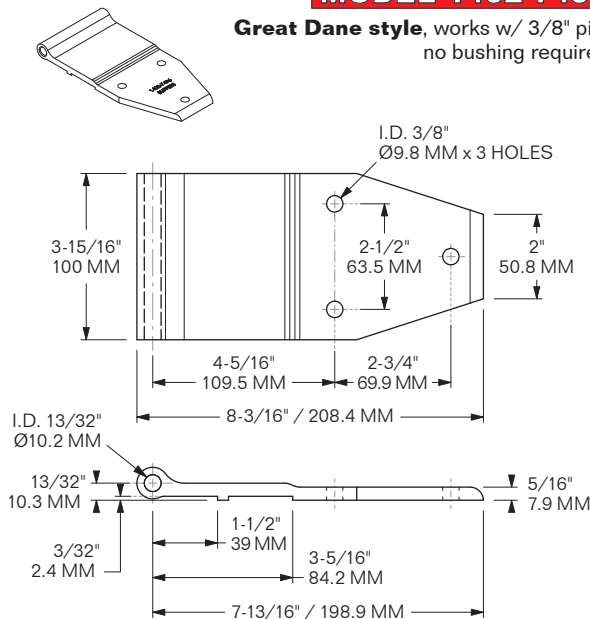

SUB FOR: GREAT DANE 15152, FLEET ENG. 022-01007
MATERIAL: ALUMINUM **FINISH:** SELF-COLOR
WEIGHT: 0.92 LBS / 0.42 Kg

MODEL 1402-7497

Great Dane style,
works w/ 1/2" pin,
includes nylon bushing

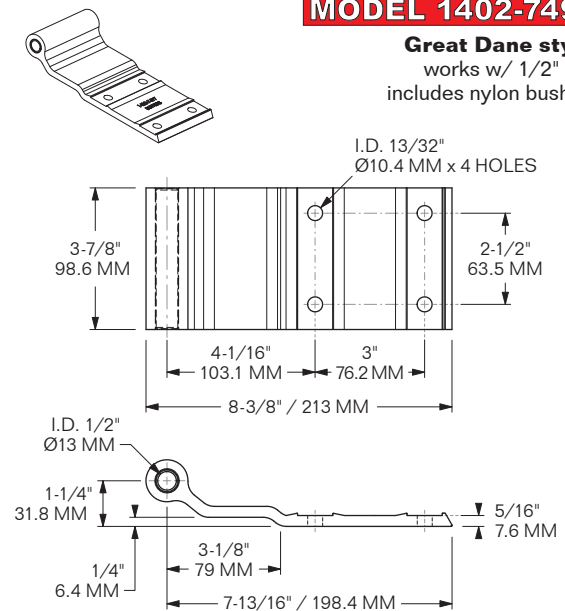

SUB FOR: GREAT DANE 31800904,
 FLEET ENGINEERS 022-01009
MATERIAL: ALUMINUM **FINISH:** SELF-COLOR
WEIGHT: 1.2 LBS / 0.54 Kg

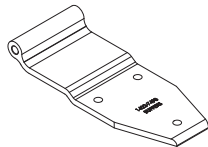

MODEL 1402-7498

Great Dane style,
works w/ 3/8" pin,
no bushing required

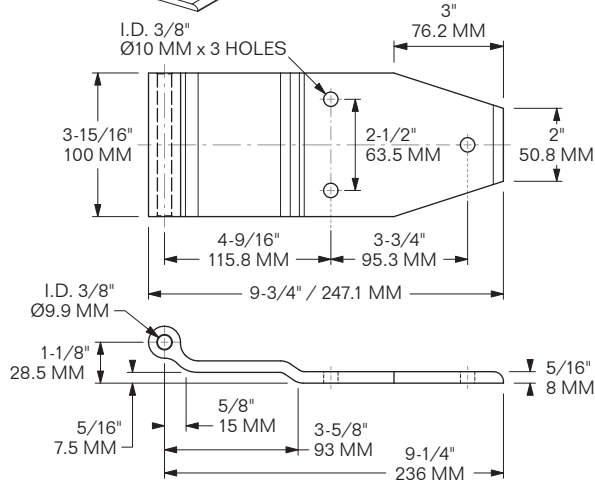

SUB FOR: GREAT DANE 47563, FLEET ENG. 022-01058
MATERIAL: ALUMINUM **FINISH:** SELF-COLOR
WEIGHT: 1.23 LBS / 0.56 Kg
WORKS WITH: 1402-7542 HINGE PIN

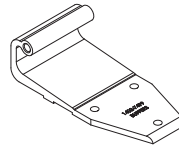

MODEL 1402-7499

Great Dane style (reefer),
works w/ 3/8" pin,
no bushing required

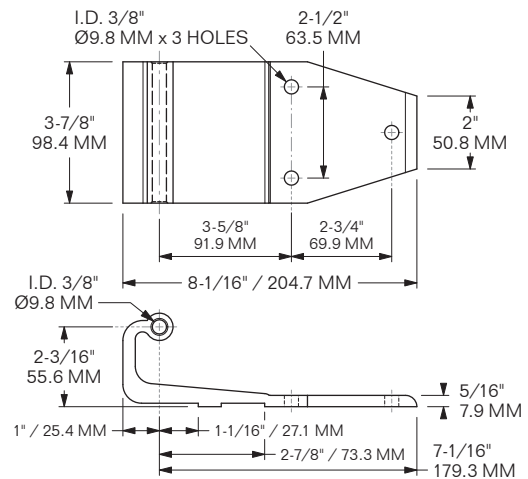

SUB FOR: GREAT DANE 08206, FLEET ENG. 023-00562
MATERIAL: ALUMINUM **FINISH:** SELF-COLOR
WEIGHT: 1.41 LBS / 0.64 Kg
WORKS WITH: 1402-7542 HINGE PIN

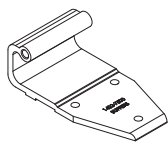

MODEL 1402-7500

Great Dane style (dry freight),
works w/ 3/8" pin,
no bushing required

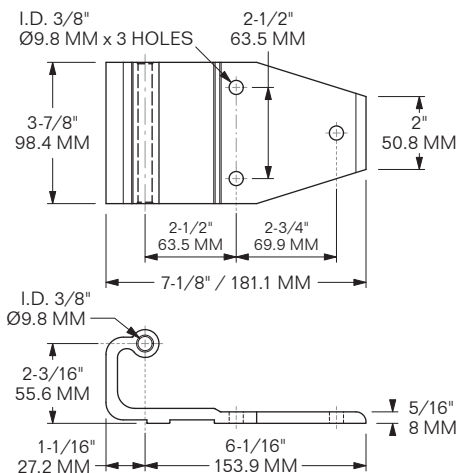

SUB FOR: GREAT DANE 08138, FLEET ENG. 023-00563
MATERIAL: ALUMINUM **FINISH:** SELF-COLOR
WEIGHT: 1.13 LBS / 0.51 Kg
WORKS WITH: 1402-7542 HINGE PIN

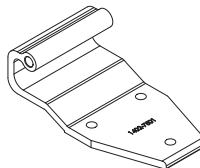

MODEL 1402-7501

Great Dane style, works w/
3/8" pin, no bushing required

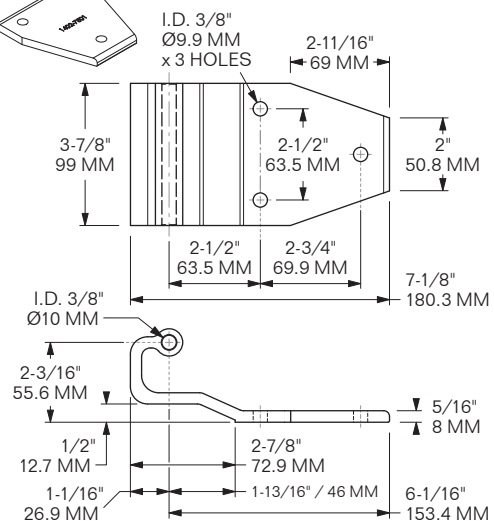

SUB FOR: GREAT DANE 42500813,
FLEET ENGINEERS 023-01656 **MATERIAL:** ALUMINUM
FINISH: SELF-COLOR **WEIGHT:** 1.06 LBS / 0.48 Kg
WORKS WITH: 1402-7542 HINGE PIN

MODEL 1402-7503

Hyundai style, works w/ 1/2" pin,
includes nylon bushing

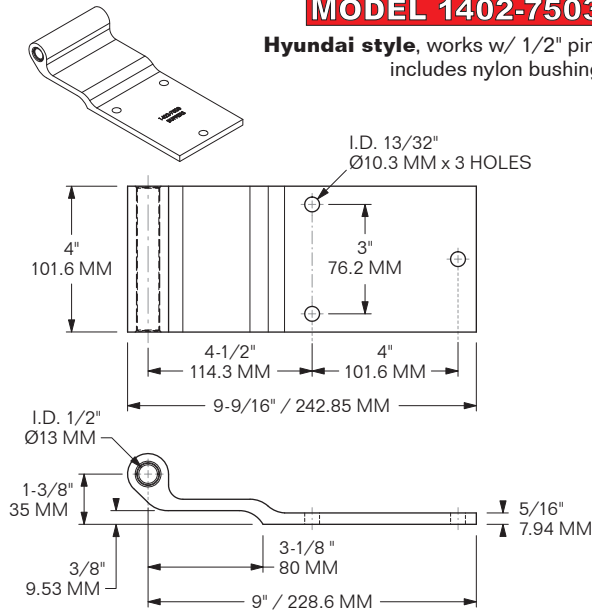

SUB FOR: HYUNDAI 20003977,
FLEET ENGINEERS 023-01657 **MATERIAL:** ALUMINUM
FINISH: SELF-COLOR **WEIGHT:** 1.46 LBS / 0.66 Kg
WORKS WITH: 1402-6230 HINGE PIN

MODEL 1402-7504

Kentucky style (Side Door)
Assembly w/ 3/8" hex bolt
pin, brackets, washers
& nylon bushings

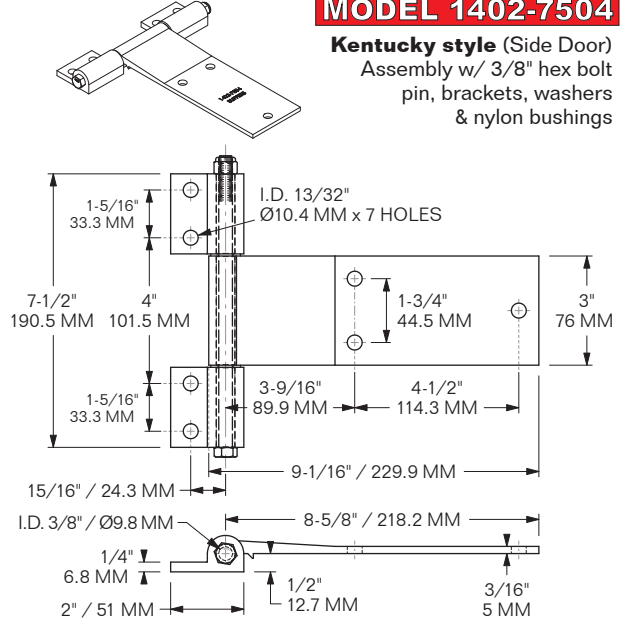

SUB FOR: KENTUCKY 6616396000R,
FLEET ENGINEERS 022-01035
MATERIAL: ALUMINUM **FINISH:** SELF-COLOR
WEIGHT: 1.47 LBS / 0.67 Kg

MODEL 1402-7505

Kentucky style (Belly Box)
Assembly w/ 3/8" hex bolt
pin, brackets, washers
& nylon bushings

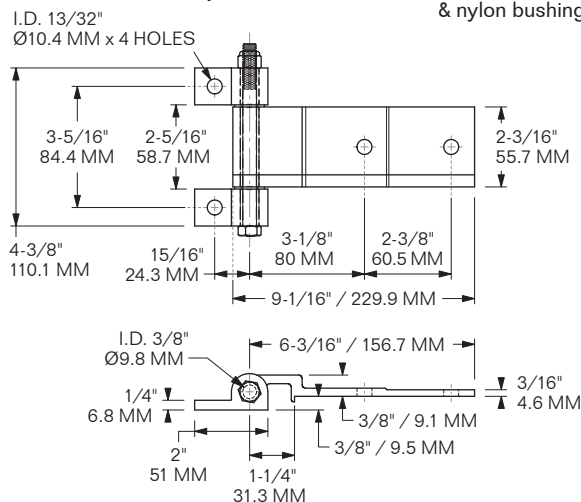

SUB FOR: KENTUCKY 6616600000,
FLEET ENGINEERS 022-01040
MATERIAL: ALUMINUM **FINISH:** SELF-COLOR
WEIGHT: 0.65 LBS / 0.29 Kg

MODEL 1402-7507

Manac style, works w/ 1/2" pin,
no bushing required

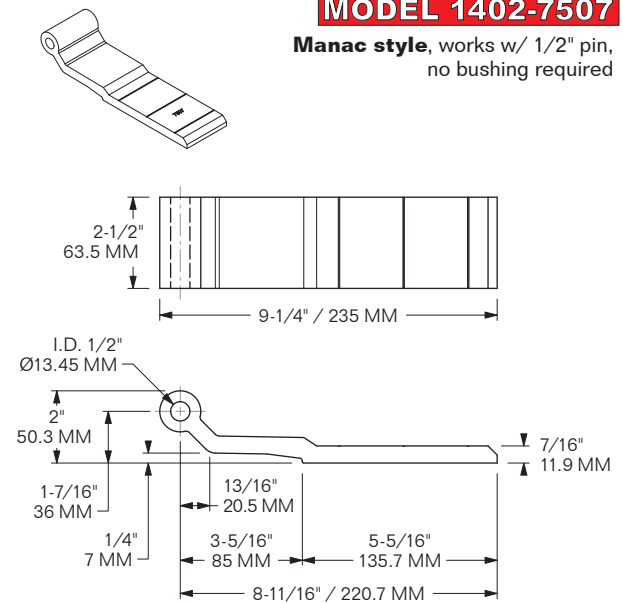

SUB FOR: MANAC 353-239, FLEET ENG. 022-01043
MATERIAL: ALUMINUM **FINISH:** SELF-COLOR
WEIGHT: 1.16 LBS / 0.53 Kg
WORKS WITH: 1402-7541 HINGE PIN

MODEL 1402-7507-D

Manac style, works w/ 1/2" pin,
no bushing required

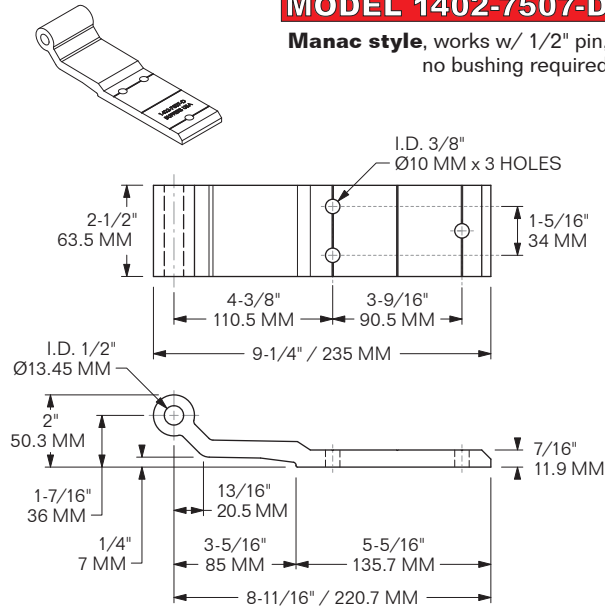

SUB FOR: MANAC V3K00002, FLEET ENG. 022-01041
MATERIAL: ALUMINUM **FINISH:** SELF-COLOR
WEIGHT: 1.1 LBS / 0.48 Kg
WORKS WITH: 1402-7541 HINGE PIN

MODEL 1402-7508

Monon style, works w/ 1/2" pin,
no bushing required

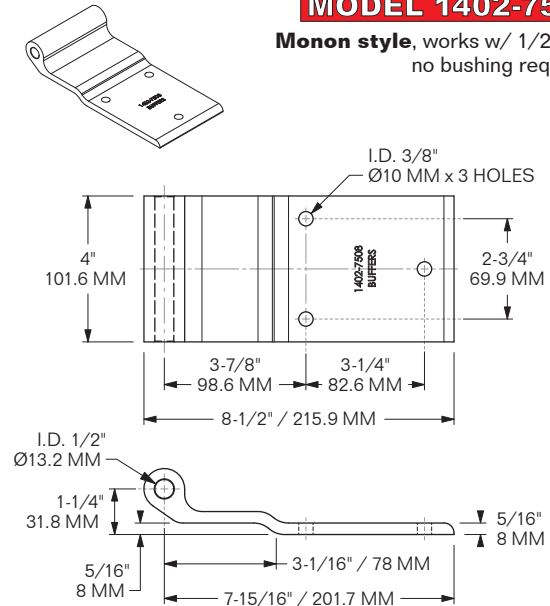

SUB FOR: MONON PC1310, FLEET ENG. 022-00996
MATERIAL: ALUMINUM **FINISH:** SELF-COLOR
WEIGHT: 1.32 LBS / 0.6 Kg **WORKS WITH:**
 1402-2350 HINGE BRACKET & 1402-6230 HINGE PIN

MODEL 1402-7509

Monon style, works w/ 1/2" pin,
includes nylon bushing

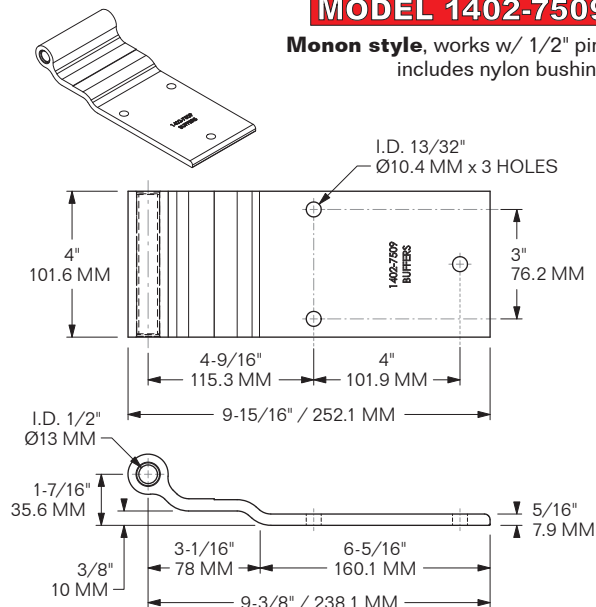

SUB FOR: MONON ED045011, FLEET ENG. 022-01185
MATERIAL: ALUMINUM **FINISH:** SELF-COLOR
WEIGHT: 1.36 LBS / 0.62 Kg
WORKS WITH: 1402-6230 HINGE PIN

MODEL 1402-7510

Vanguard style, works w/ 1/2" pin,
includes nylon bushing

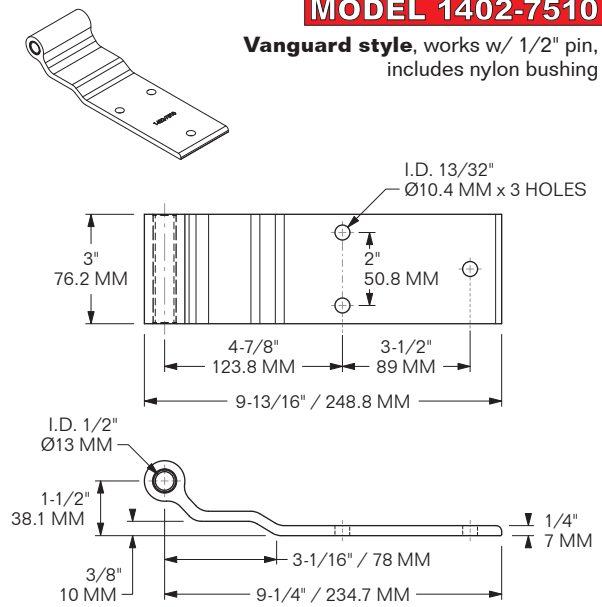

SUB FOR: VANGUARD RFP00127, FLEET ENG. 022-01407
MATERIAL: ALUMINUM **FINISH:** SELF-COLOR
WEIGHT: 1 LB / 0.45 Kg
WORKS WITH: 1402-7541 HINGE PIN

MODEL 1402-7512

Pines style, works w/ 1/2" pin,
no bushing required

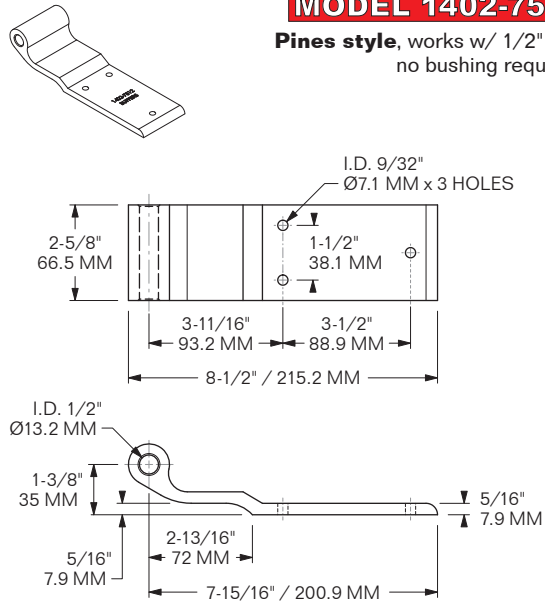

SUB FOR: PINES AE54111, FLEET ENG. 022-00995
MATERIAL: ALUMINUM **FINISH:** SELF-COLOR
WEIGHT: 0.86 LBS / 0.39 Kg **WORKS WITH:**
 1402-2340 HINGE BRACKET & 1402-7541 HINGE PIN

MODEL 1402-7513

Stoughton style, works w/ 1/2" pin,
includes nylon bushing

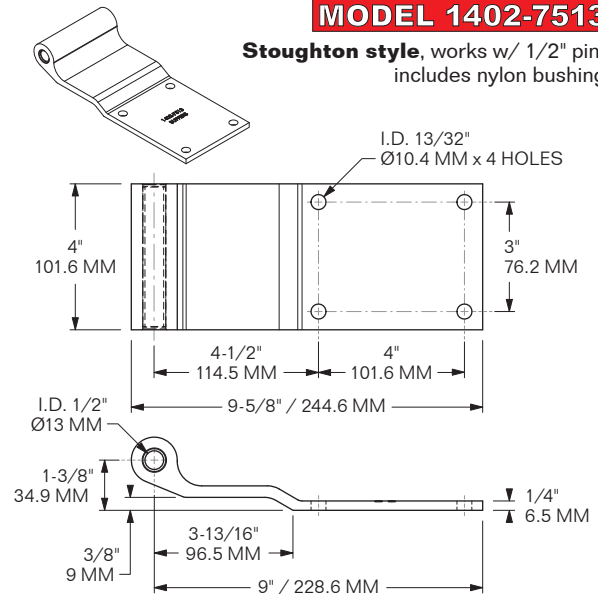

SUB FOR: STOUGHTON 04-08316-000-00,
 FLEET ENGINEERS 022-01008
MATERIAL: ALUMINUM **FINISH:** SELF-COLOR
WEIGHT: 1.39 LBS / 0.63 Kg **WORKS WITH:**
 1402-2393 HINGE BRACKET & 1402-6230 HINGE PIN

MODEL 1402-7514

Stoughton style, works w/ 1/2" pin,
includes nylon bushings

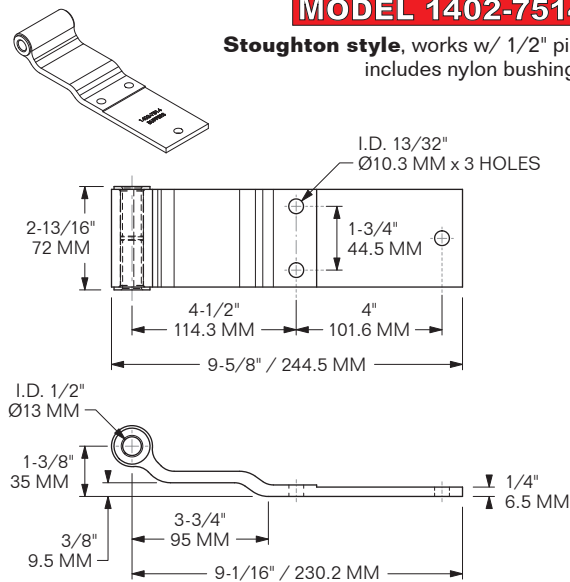

SUB FOR: STOUGHTON 04-86386-001-00,
 MINER H-1086, FLEET ENGINEERS 022-01081
MATERIAL: ALUMINUM **FINISH:** SELF-COLOR
WEIGHT: 0.85 LBS / 0.39 Kg **WORKS WITH:**
 1402-2393 HINGE BRACKET & 1402-6230 HINGE PIN

MODEL 1402-7515

Strick style, works w/ 1/2" pin,
includes nylon bushing

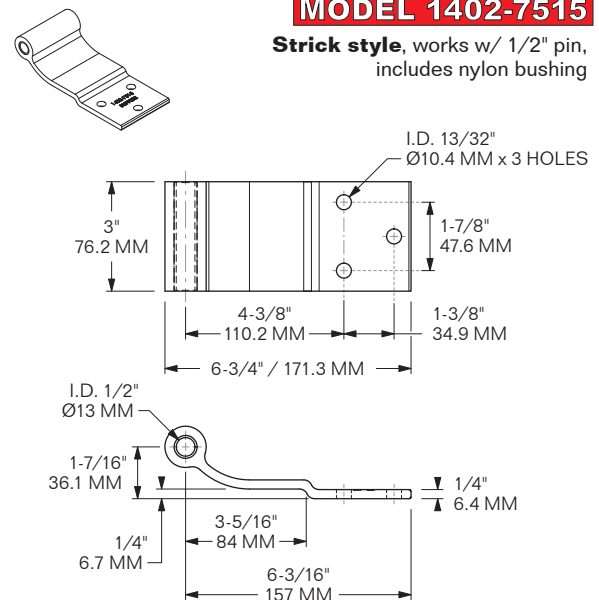

SUB FOR: STRICK AA35F00100100, FLEET ENG. 022-01003
MATERIAL: ALUMINUM **FINISH:** SELF-COLOR
WEIGHT: 0.64 LBS / 0.29 Kg **WORKS WITH:**
 1402-7541 HINGE PIN

MODEL 1402-7516

Strick style, works w/ 1/2" pin,
includes nylon bushing

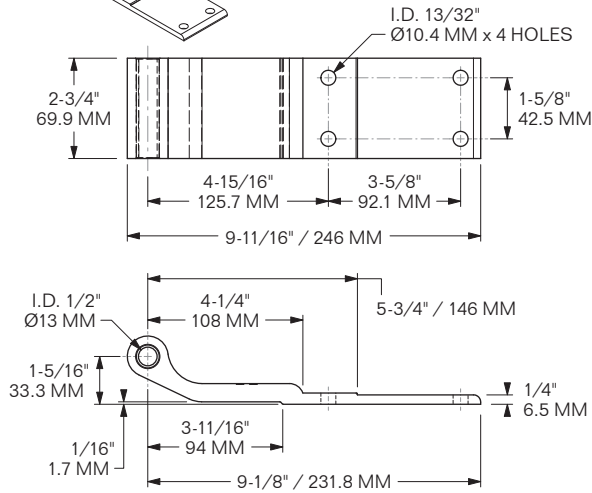

SUB FOR: STRICK AA35F00230100, FLEET ENG. 022-01013
MATERIAL: ALUMINUM **FINISH:** SELF-COLOR
WEIGHT: 1.09 LBS / 0.49 Kg
WORKS WITH: 1402-7541 HINGE PIN

MODEL 1402-7517

Trailmobile style, works w/
5/8" pin, no bushing required

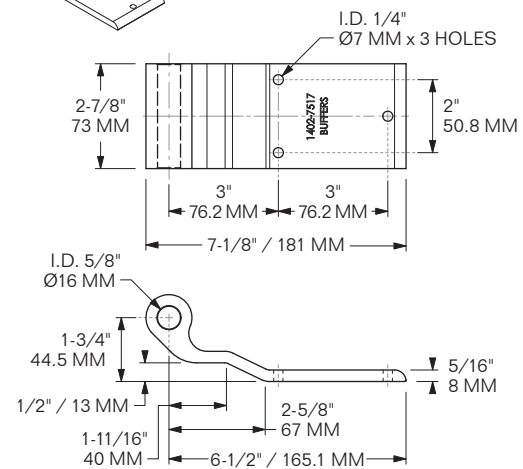

SUB FOR: TRAILMOBILE 515-10-65,
FLEET ENGINEERS 022-00966
MATERIAL: ALUMINUM **FINISH:** SELF-COLOR
WEIGHT: 0.88 LBS / 0.4 Kg
WORKS WITH: 1402-7544 HINGE PIN

MODEL 1402-7519

Kentucky style, works w/ 1/2" pin,
no bushing required

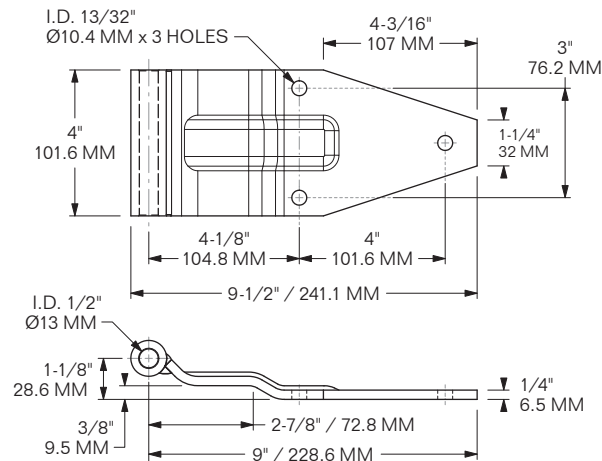

SUB FOR: KENTUCKY 2906, FLEET ENG. 022-00614
MATERIAL: FAB. STEEL **FINISH:** ZINC-PLATED
WEIGHT: 2.7 LBS / 1.22 Kg **WORKS WITH:**
 1402-2350 HINGE BRACKET & 1402-6230 HINGE PIN

MODEL 1402-7520

Utility style, works w/ 1/2" pin,
no bushing required

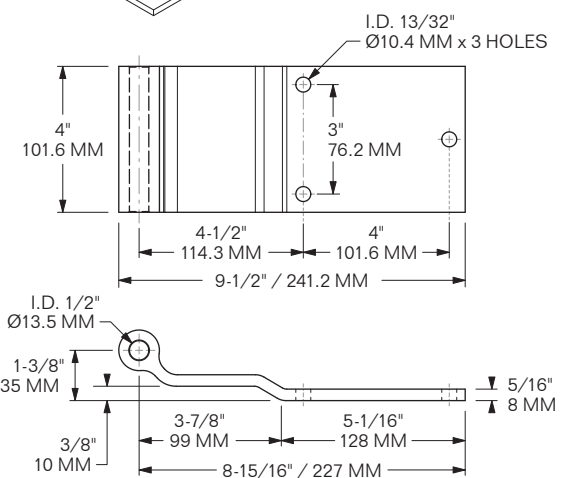

SUB FOR: UTILITY 03-4100-0-019, FLEET ENG. 022-01056
MATERIAL: ALUMINUM **FINISH:** SELF-COLOR
WEIGHT: 1.38 LBS / 0.62 Kg

MODEL 1402-7521

Utility style, works w/ 1/2" pin,
no bushing required

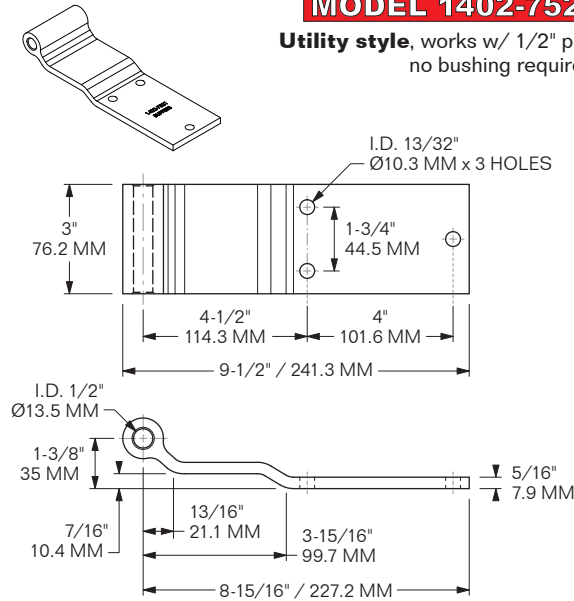

SUB FOR: UTILITY 03-4100-0-022,
FLEET ENGINEERS 022-01184
MATERIAL: ALUMINUM **FINISH:** SELF-COLOR
WEIGHT: 1.02 LBS / 0.46 Kg

MODEL 1402-7523

Wabash style, works w/ 1/2" pin,
no bushing required

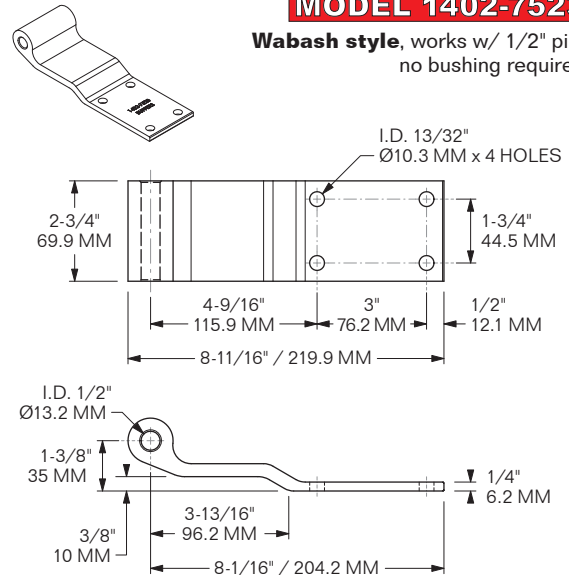

SUB FOR: WABASH 6301272 & 21101272,
FLEET ENG. 022-01047 **MATERIAL:** ALUMINUM
FINISH: SELF-COLOR **WEIGHT:** 0.94 LBS / 0.43 Kg
WORKS WITH: 1402-2340 HINGE BRACKET
& 1402-7541 HINGE PIN

MODEL 1402-7524

Wabash style, works w/ 1/2" pin,
includes nylon bushings

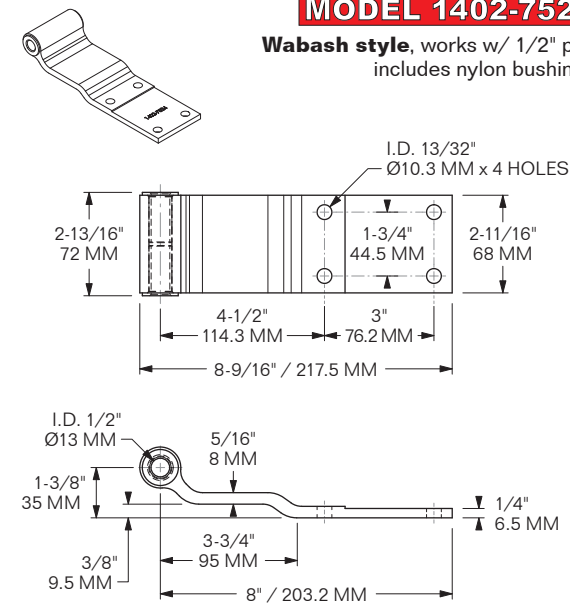

SUB FOR: WABASH 06301527, FLEET ENG. 022-01182
MATERIAL: ALUMINUM **FINISH:** SELF-COLOR
WEIGHT: 0.81 LBS / 0.37 Kg **WORKS WITH:**
1402-2340 HINGE BRACKET & 1402-7541 HINGE PIN

MODEL 1402-7526

Stoughton style, works w/ 1/2" pin,
includes nylon bushings

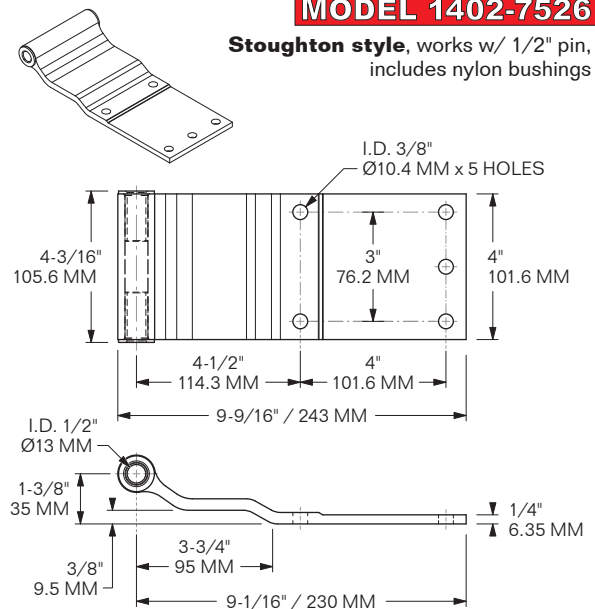

SUB FOR: STOUGHTON P108540, MINER H-1085,
FLEET ENG. 022-01086 **MATERIAL:** ALUMINUM
FINISH: SELF-COLOR **WEIGHT:** 1.2 LBS / 0.54 Kg
WORKS WITH: 1402-7541 HINGE PIN

MODEL 1402-8229

Vanguard style (reefer), works w/ 1/2" pin, includes nylon bushing

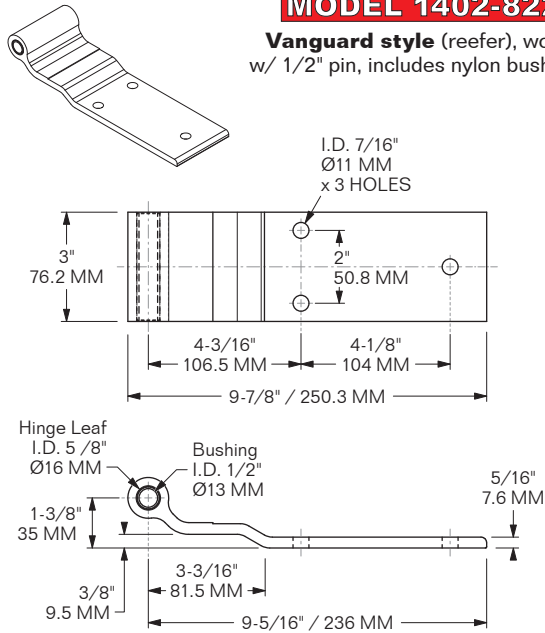

SUB FOR: VANGUARD CRTN8514104-A201
MATERIAL: ALUMINUM **FINISH:** SELF-COLOR
WEIGHT: 1 LB / 0.46 Kg

MODEL 1402-8230

Hyundai style (reefer), works w/ 1/2" pin, includes nylon bushing

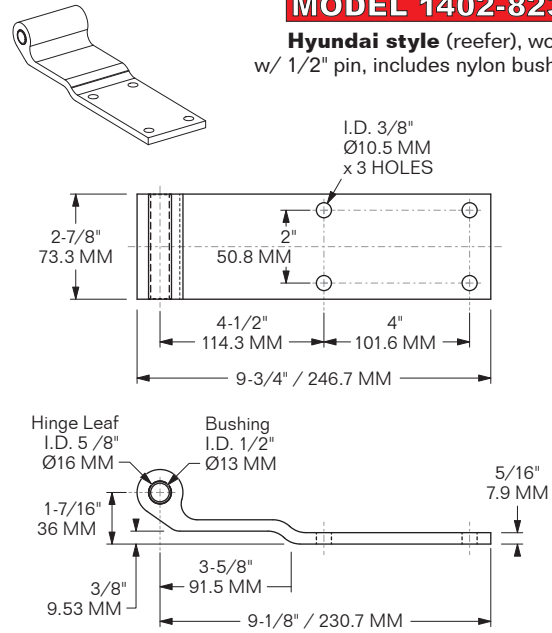

SUB FOR: HYUNDAI 10011746
MATERIAL: ALUMINUM **FINISH:** SELF-COLOR
WEIGHT: 1.1 LBS / 0.5 Kg

MODEL 1402-8983

Great Dane style (reefer), works w/ 3/8" pin, includes nylon bushing

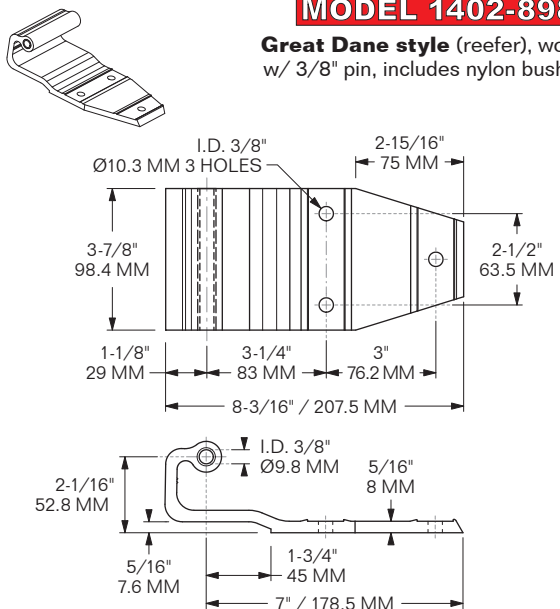

SUB FOR: GREAT DANE 31806105
MATERIAL: ALUMINUM **FINISH:** SELF-COLOR
WEIGHT: 1.32 LBS / 0.6 Kg
WORKS WITH: 1402-7542 HINGE PIN

MODEL 1402-9007

Kentucky style, works w/ 1/2" pin, no bushing required

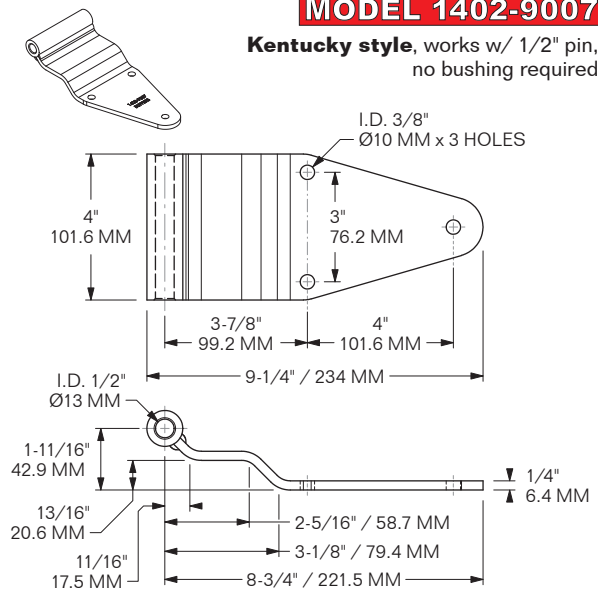

SUB FOR: KENTUCKY 6650000002, EBERHARD 31-5897-2 & 31-5897-50-13
MATERIAL: STEEL **FINISH:** HOT-DIP GALVANIZED
WEIGHT: 2.65 LBS / 1.2 Kg
WORKS WITH: 1402-9011 BRACKET